WB2

User Manual for
the Khons EVSE
APP Device

CATALOGUE

Scan the brochure's bottom QR code to download APP.

一.	APP Registration and Login	3
1.1	Registration Information	
1.2	Login Operation	
1.3	Introduction to the Main Interface	
二.	Device Binding	4
2.1	Scan device accessory	
2.2	Complete device binding	
2.3	Auto-connect to Wi-Fi	
2.4	Binding succeeded	
三.	Equipment Configuration	5
3.1	First Use Configuration APP Work Mode	
3.2	Switching Network Connection Method	
3.3	Complete WiFi Configuration	
四.	Equipment Interface Interpretation	6
4.1	Charging Parameter Interface	
4.2	Charging Record Interface	
4.3	Pre-booking Charging Interface	
五.	Device Sharing & Binding	7
5.1	Device Sharing	
5.2	Device Unbinding	
	QR Code for APP Download & Operation Videos	

Note:

This manual is exclusively for WB2 charging devices manufactured by our company. It provides detailed instructions for device registration, login, binding, configuration, and usage through the KHONS EVSE APP. Actual operation shall follow the physical device specifications. The app is available for download via the App Store on iOS and GooglePlay on Android.

一、App Registration and Login

1.1 Registration Information Filling

After opening the KHONS EVSE APP and entering the registration interface, you need to fill in the following information to complete registration:

Email: for login verification and account recovery
Nickname: Display name for self-created account
Password: Set a secure login password

Check "I have read and agree to the User Agreement and Privacy Policy", then click [Register] to complete registration.

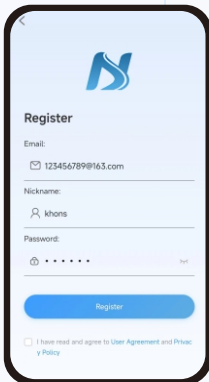

1.2 Login

After registration, log in to the app by following these steps Enter the email and password used for registration on the login page.

Check the user agreement and privacy policy, then click [Login] to complete login.

To recover your password, click [Forgot Password?] and follow the instructions.

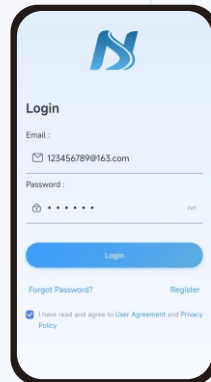

1.3 Introduction to the Main Interface

When no devices are bound, the main interface displays a "No Devices" message with the prompt: "You have not bound any charging devices. Add a device!"

Add device entry:
The [Add Device] button in the center of the screen or the "+" button in the top-right corner.

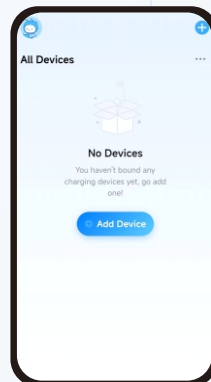

二、Device Binding

2.1 Scanning device accessories

Tap **[Add Device]** to enter the device search interface. Enable Bluetooth on your mobile phone and grant Bluetooth permissions to the app. The app will then automatically search for devices within the Bluetooth range. The search results will display the device names (e.g., WGYCE0001, H0TEST007) and their corresponding MAC addresses (e.g., 94:C9:60:D2:AF:E3).

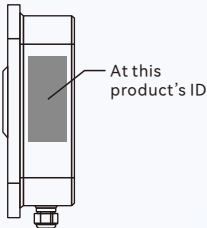
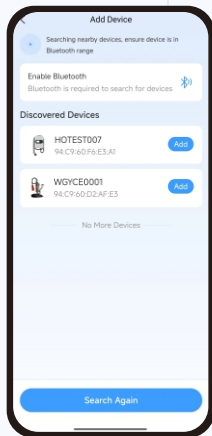

Product ID
Obtain the Product ID from the side label of the device or the user manual.

2.2 Complete device binding

Click the **[Add]** button next to the target device in the search results to enter the binding process. The interface will sequentially display "Establishing Bluetooth Connection", "Bluetooth Connection Successful", and "Binding Device". After the prompt "Device Binding Successful" appears, the device will be added to the "My Devices" list.

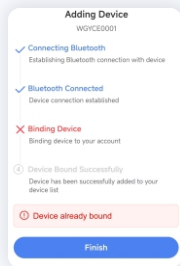
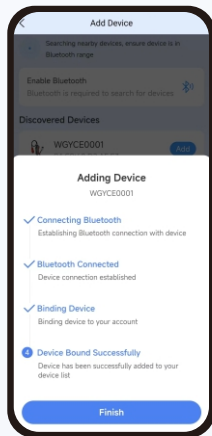

Failed Binding Cases
Do not re-bind the same device; otherwise, binding will fail.

2.3 Auto-connect to Wi-Fi

Once device binding is completed, WiFi details will be automatically shared for network connection.

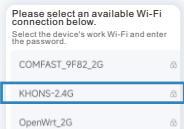
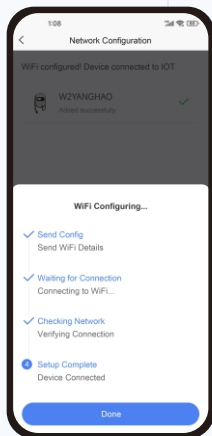

Select WiFi
Connect device to WiFi:
Prioritize 2.4G

2.4 Binding successful

After successful binding, when entering the device details page for the first time:

- When offline, the status will show as "Unknown Status".
- When online, the status will show as "free".

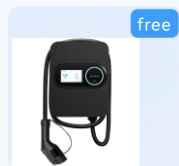
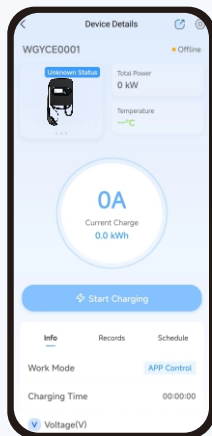

Connected to WiFi

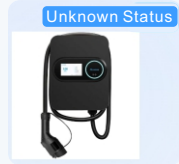

Not connected to Wi-Fi



If Bluetooth or network configuration fails to connect more than twice, restart the device to reconnect!

三、Equipment Configuration

3.1 First-time use of the configuration APP working mode

- ① Go to the device details page, click the "Settings" button at the bottom right, and enter the "Device Configuration" interface. Wait for the data to load.
- ② In the "Basic Settings" section, locate "Work Mode" and click to access the switch interface.
- ③ The available modes are "APP Control" and "Plug and Play". Select your preferred mode and click [Confirm].
- ④ Set parameters such as "Charging Current", "Grounding Switch", and "Time Zone" according to requirements.

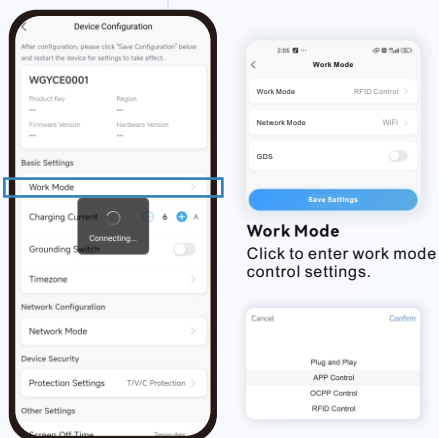

3.2 Switching between networking methods

In the Device Configuration interface, locate Network Configuration. Click Network Mode, select WiFi as the connection method, and click Confirm.

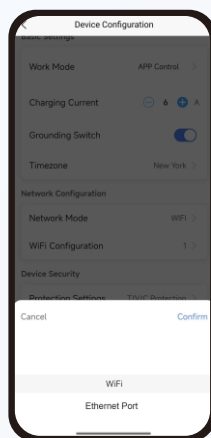

If you didn't enable network during device binding, connect to the network to access the device settings interface.

3.3 WiFi Network Setup

- ① In "WiFi Configuration", select the target WiFi or enter its WiFi Name and WiFi Password;
- ② After configuration, tap [Save Configuration] and restart the device for the settings to take effect;
- ③ Once the device restarts, re-enter the details page. If "Idle" is displayed in the top-right corner, it indicates a successful network connection.

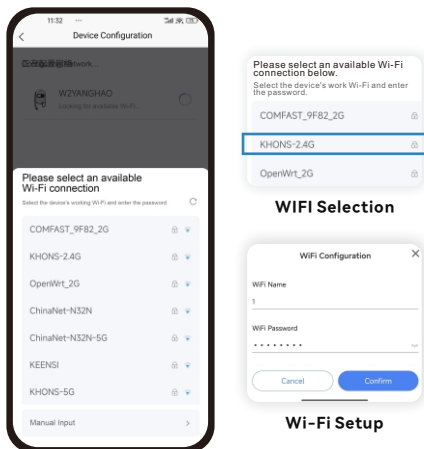

四、 Interpretation of the device usage interface

4.1 Charging Parameter Interface

View real-time charging parameters on the device details page, including:

Charging Time

Three-phase voltage (Voltage: Phase A/B/C)

Three-phase current (Current: Phase A/B/C)

Three-phase power (Power: Phase A/B/C)

Current Charge

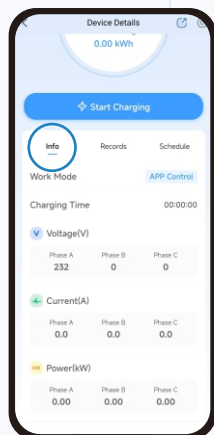

Current Charge Level

4.2 Charging Record Interface

Click the [Records] button on the details page to enter the charging records interface:

Use the Time Filter to select the query range

(Today, 7 Days, 30 Days, or custom start/end dates)

The record list displays the date, kWh, charging period, and duration of each charge.

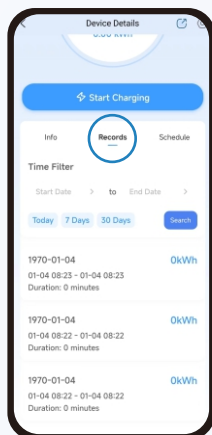

4.3 Charging Reservation Interface

Click the Schedule button on the details page to set up a charging appointment.

Enable Schedule Set "Start Time" and "Duration";

The device will start charging automatically at the scheduled time after saving.

Note:

- ① Please schedule charging before plugging in the vehicle-side connector.
- ② After reservation, click Save Settings.

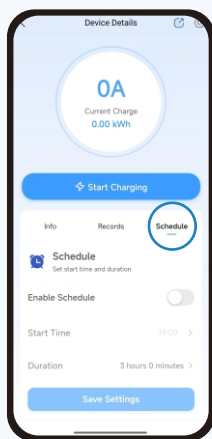

Set Charging Start Time

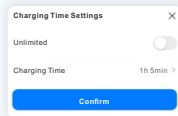

Set charging duration
Adjust precision to seconds.

五、Device Sharing and Unbinding

5.1 Equipment Sharing

On the device details page, you can share device information with others via the "Share" function. Click the second icon in the top right corner to share.



[Device online details interface]

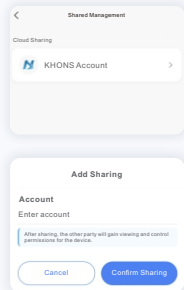

Account Sharing Management

Enter the device ID to share device control permissions.

5.2 Unbind the Device

Click the [Unbind Device] button on the device settings page. In the unbinding interface:

directly release control of the device via the [Unbind] button.

When bound, the device cannot be linked to other users. Only after unbinding can it be freely bound to other accounts.

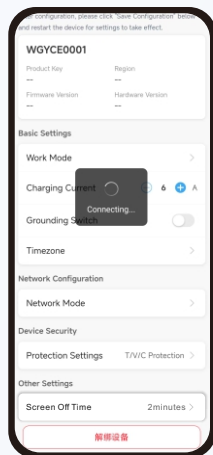

[Device configuration basic settings interface Figure]

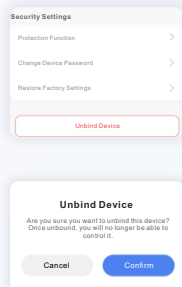

APP Download Link & Tutorial Video



Apple App



Android app



Operation video